

## Quick Start Guide

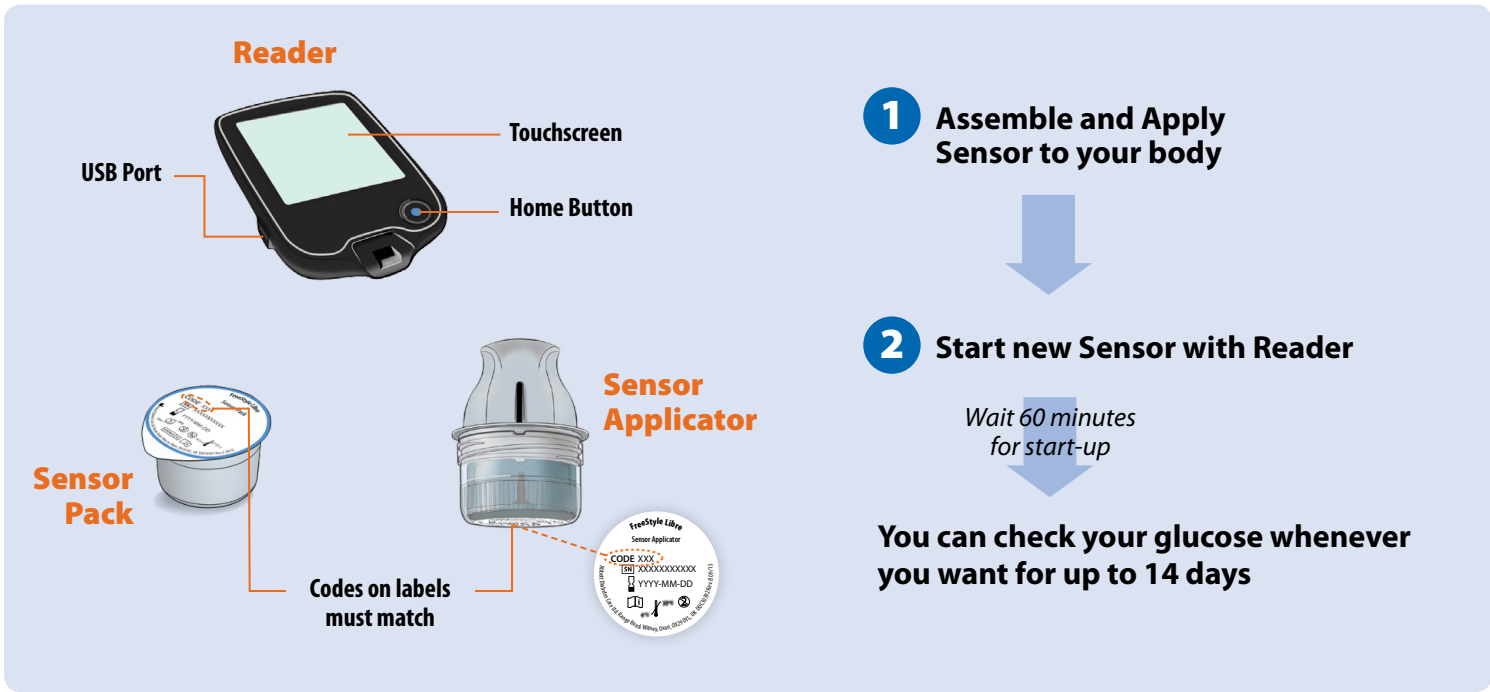

## Setup Overview

Refer to your User's Manual for full system instructions and information.



## 1 Assemble and Apply Sensor to your body

### Get Ready

#### STEP 1

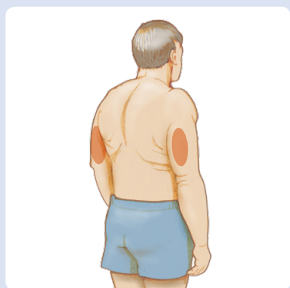

Select site on back of upper arm.

**Note:** Avoid scars, moles, stretch marks, lumps and insulin injection sites. To prevent skin irritation, rotate sites between applications. Consider your comfort and activities.

#### STEP 2



Clean site with alcohol wipe. Allow site to dry before proceeding.

#### STEP 3

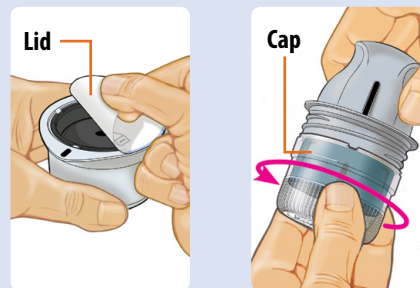

Peel lid completely off Sensor Pack. Unscrew cap from Sensor Applicator.

**CAUTION:** Sensor codes must match on Sensor Pack and Sensor Applicator.

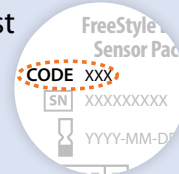

### Prepare Sensor Applicator

#### STEP 4

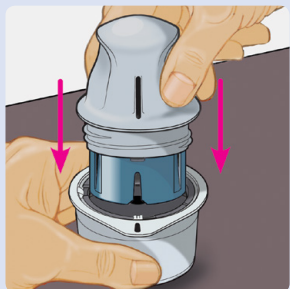

Line up dark mark on Sensor Applicator with dark mark on Sensor Pack. On a hard surface, press down firmly on Sensor Applicator until it comes to a stop.

#### STEP 5

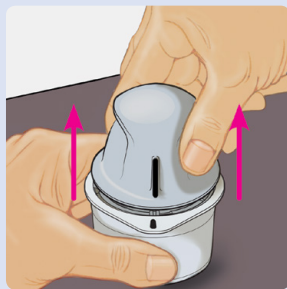

Lift Sensor Applicator out of Sensor Pack.

#### STEP 6



Sensor Applicator is ready to apply Sensor.

**CAUTION:** Sensor Applicator now contains a needle. Do not touch inside Sensor Applicator or put it back into Sensor Pack.

### Apply Sensor

#### STEP 7

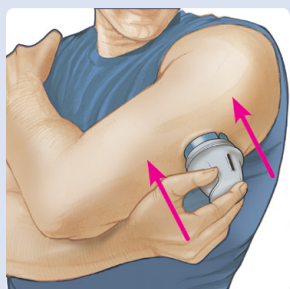

Place Sensor Applicator over site and push down firmly to apply Sensor.

**CAUTION:** Do not push down on Sensor Applicator until placed over prepared site to prevent unintended results or injury.

#### STEP 8

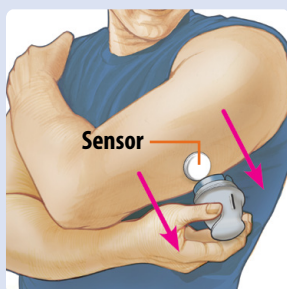

Gently pull Sensor Applicator away from your body.

#### STEP 9



Make sure Sensor is secure. Discard used Sensor Applicator and Sensor Pack according to local regulations.



## 2 Start new Sensor with Reader

### STEP 1

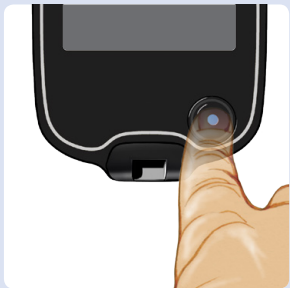

Press Home Button to turn on Reader.  
**Note:** If using Reader for the first time, follow the prompts to set date, time and target glucose range.

### STEP 2



Touch **Start New Sensor**.

### STEP 3



Hold Reader within 4 cm (1.5 inches) of Sensor to scan it.  
Sensor can be used to check your glucose after 60 minutes.



## 3 Check your glucose

### STEP 1

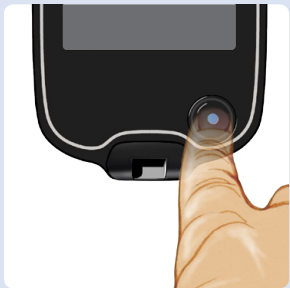

Press Home Button to turn on Reader.

### STEP 2



Hold Reader within 4 cm (1.5 inches) of Sensor to scan it.

### STEP 3

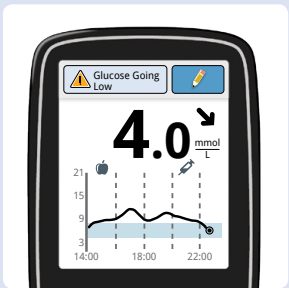

Reader shows your glucose readings.

### Understanding your glucose readings

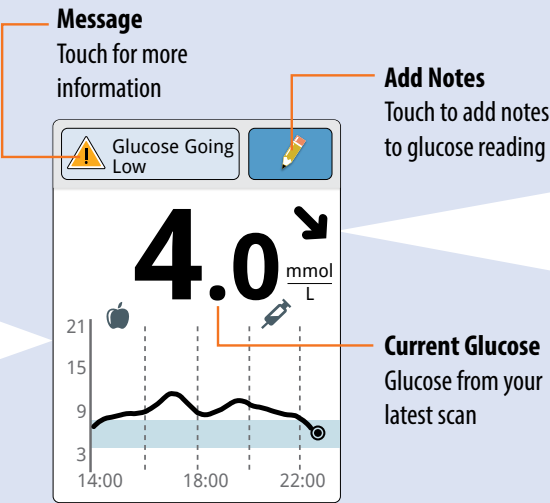
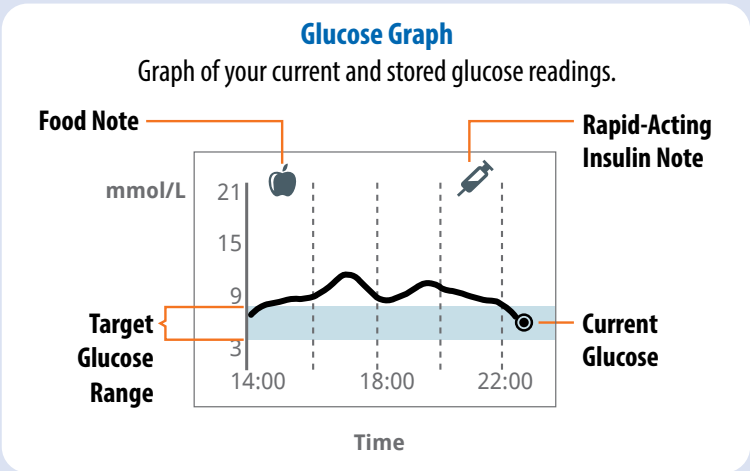

Glucose Trend Arrow	
Direction your glucose is going	
Arrow	What it means
↑	Glucose rising quickly
↗	Glucose rising
→	Glucose changing slowly
↘	Glucose falling
↓	Glucose falling quickly

## 4 Review your history

### STEP 1

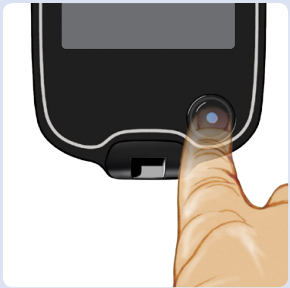

Press Home Button to turn on Reader. Press Home Button again to go to Home Screen.



### STEP 2



Touch **Review History**.

### STEP 3

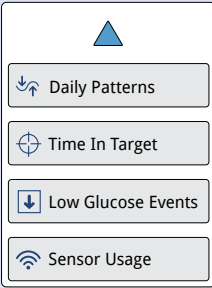
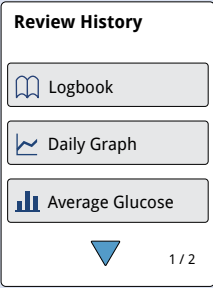

Select option to view.

If you have followed the instructions described in the User's Manual and are still having difficulty setting up your System or if you are experiencing symptoms that are not consistent with your glucose monitoring, contact your health care professional.

FreeStyle and related brand marks are trademarks of Abbott Diabetes Care Inc. in various jurisdictions. ©2016 Abbott ART28735-001 Rev. B 11/16



Abbott Diabetes Care Ltd.  
Range Road  
Witney, Oxon  
OX29 0YL, UK

