



FreeStyle Libre

FLASH GLUCOSE MONITORING SYSTEM

Quick Start Guide



Setup Overview

Refer to your User's Manual for full system instructions and information.

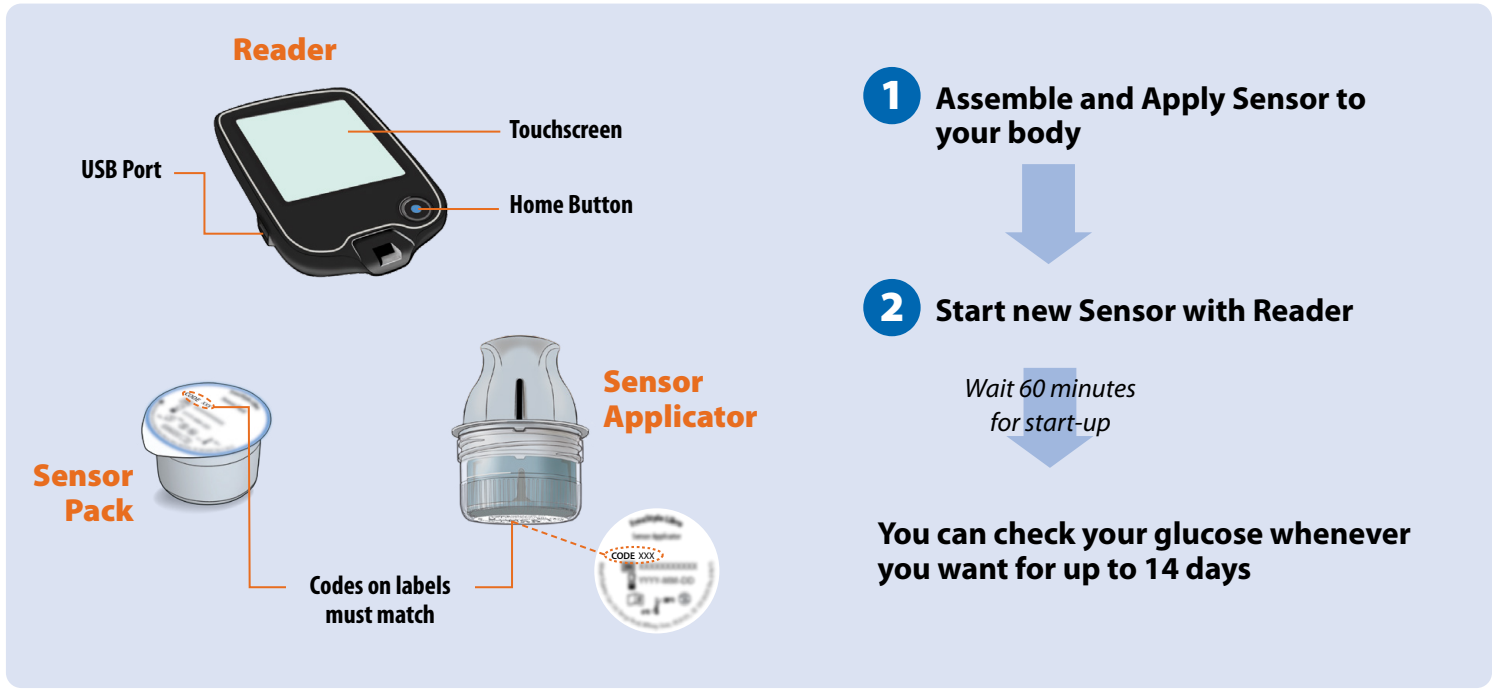

1 Assemble and Apply Sensor to your body

Get Ready

STEP 1

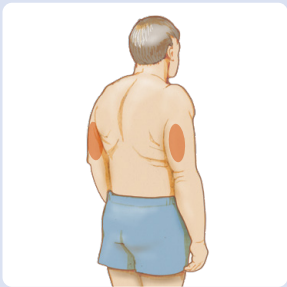

Select site on back of upper arm.

Note: Avoid scars, moles, stretch marks, lumps, and insulin injection sites. To prevent skin irritation, rotate sites between applications. Consider your comfort and activities.

STEP 2



Wash site using a plain soap, dry, and then clean with an alcohol wipe. Allow site to air dry before proceeding.

STEP 3

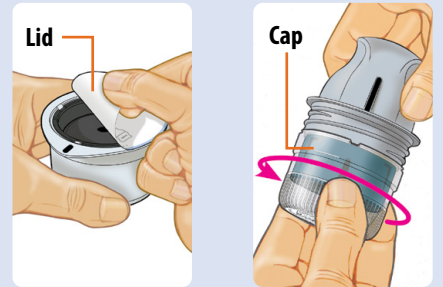

Peel lid completely off Sensor Pack. Unscrew cap from Sensor Applicator.

CAUTION: Sensor codes must match on Sensor Pack and Sensor Applicator.

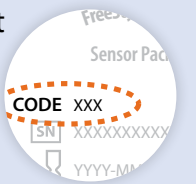

Prepare Sensor Applicator

STEP 4

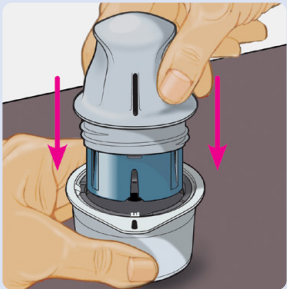

Line up dark mark on Sensor Applicator with dark mark on Sensor Pack. On a hard surface, press down firmly on Sensor Applicator until it comes to a stop.

STEP 5



Lift Sensor Applicator out of Sensor Pack.

STEP 6



Sensor Applicator is ready to apply Sensor.

CAUTION: Sensor Applicator now contains a needle. Do not touch inside Sensor Applicator or put it back into Sensor Pack.

Apply Sensor

STEP 7

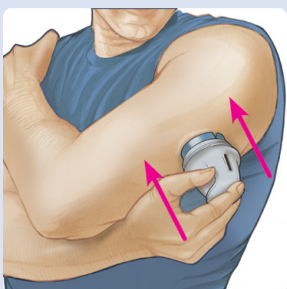

Place Sensor Applicator over site and push down firmly to apply Sensor.

CAUTION: Do not push down on Sensor Applicator until placed over prepared site to prevent unintended results or injury.

STEP 8

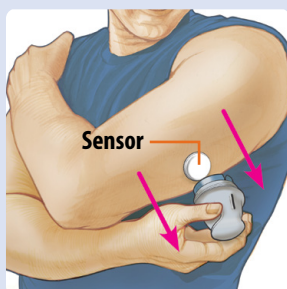

Gently pull Sensor Applicator away from your body.

STEP 9



Make sure Sensor is secure. Discard the used Sensor Pack and Sensor Applicator. See *Disposal* section in the User's Manual.



2 Start new Sensor with Reader

STEP 1

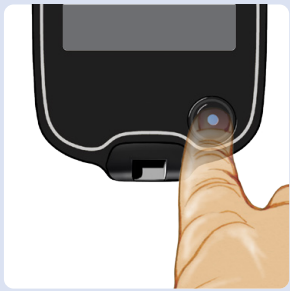

Press Home Button to turn on Reader.

Note: If using Reader for the first time, follow the prompts to set date, time, and target glucose range.

STEP 2

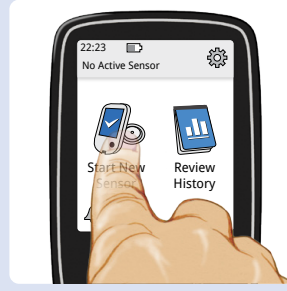

Touch **Start New Sensor**.

STEP 3



Hold Reader within 4 cm (1.5 inches) of Sensor to scan it. Sensor can be used to check your glucose after 60 minutes.



3 Check your glucose

STEP 1

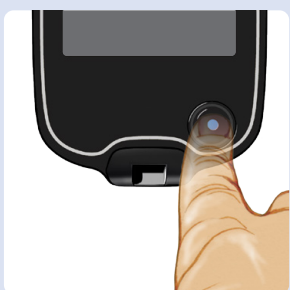

Press Home Button to turn on Reader.

STEP 2



Hold Reader within 4 cm (1.5 inches) of Sensor to scan it.

STEP 3

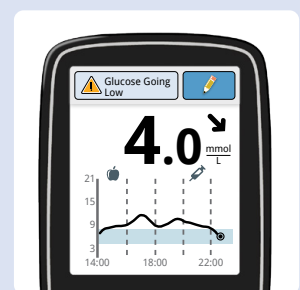

Reader shows your glucose readings.

Understanding your glucose readings

Glucose Graph

Graph of your current and stored glucose readings.

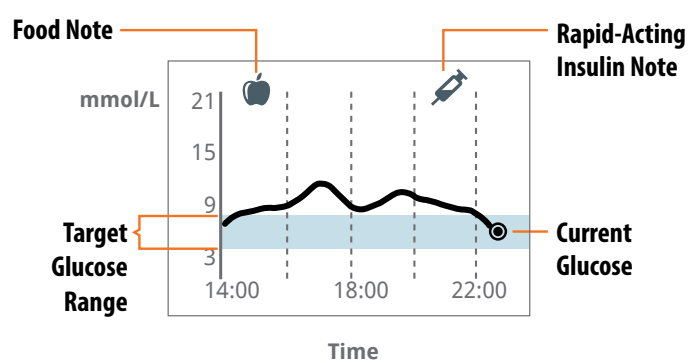

Message

Touch for more information

Add Notes

Touch to add notes to glucose reading

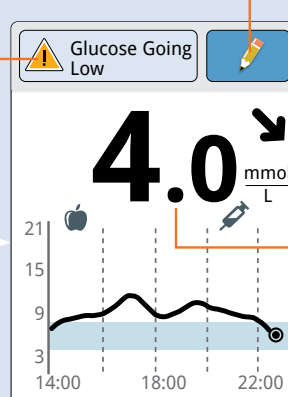

Current Glucose
Glucose from your latest scan

Glucose Trend Arrow

Direction your glucose is going

Arrow	What it means
↑	Glucose rising quickly
↗	Glucose rising
→	Glucose changing slowly
↘	Glucose falling
↓	Glucose falling quickly

4 Review your history

STEP 1

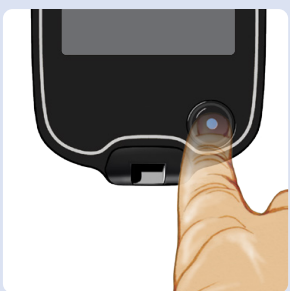

Press Home Button to turn on Reader. Press Home Button again to go to Home Screen.

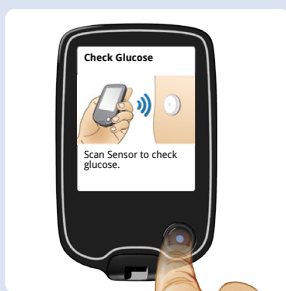

STEP 2

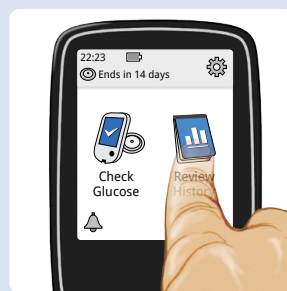

Touch **Review History**.

STEP 3

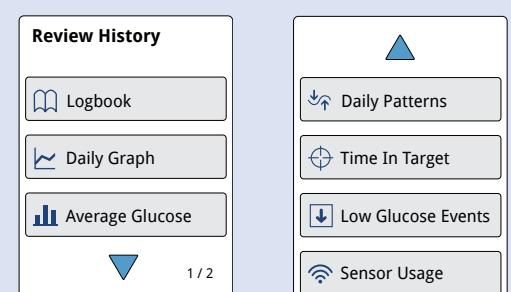

Select option to view.

If you have followed the instructions described in the User's Manual and are still having difficulty setting up your System or if you are experiencing symptoms that are not consistent with your glucose monitoring, contact your health care professional.